

LINE-DUC, JUMBO LINE-DUC Protective Guards

OVERHEAD PRODUCTS



Description:

LINE-DUC is a protective guard which can be clipped easily onto bare and covered conductors. It protects conductors from abrasion and contact by tree limbs and animals. It is extruded using black or gray, track resistant, high density polyethylene. LINE-DUC is available in standard and jumbo sizes.

Benefits:

- Eliminates conductor insulation abrasion and contact grounding
- Minimizes service interruptions and repair costs
- Prolongs useful life of conductors and cables
- Durable, economical and easy to install
- Easily installed with hot line tools
- Reduces costly tree trimming

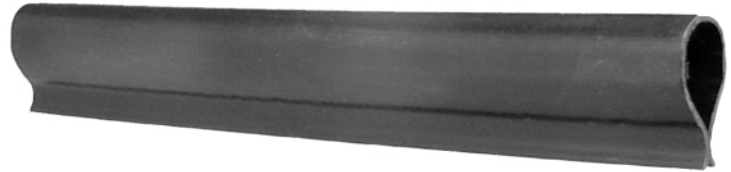

Application:

LINE-DUC can be clipped onto bare or covered conductors, service drops and communication cables. On spacer cable systems, LINE-DUC should always be used to cover the messenger near bare transformer taps in order to eliminate short circuits caused by tree limbs, birds and squirrels. Required lengths can be cut at the job site from standard 8 foot pieces. After LINE-DUC is clipped over the conductor, it is anchored at the ends with tie wire to prevent longitudinal movement along the conductor. CAUTION: LINE-DUC should not be used as a protective safety covering for energized line work. When ordering, specify black or gray color.

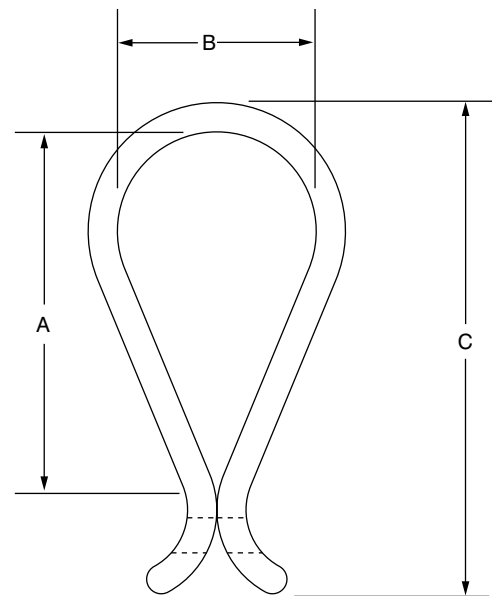
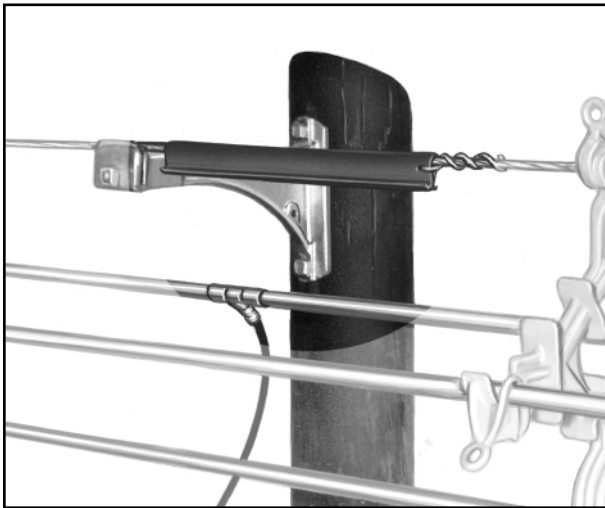

Catalog Number*	Dimension (inches)			Material	Weight (lb/ft)	Length (ft)
	A	B	C			
LINE-DUC	2	1	2 5/8	High Density Polyethylene	.38	8
JUMBO LINE-DUC	3	1 1/2	3 1/2	High Density Polyethylene	.57	8

*When ordering, specify black or gray color.

Hendrix Wire & Cable, Inc. • 53 Old Wilton Road • Milford, NH 03055-3119

Telephone: (603) 673-2040 • Fax: (603) 673-1497 • Email: overhead@hendrix-wc.com • Website: <http://www.hendrix-wc.com>

A member of The Marmon Group of companies